

Knock-down Fittings

What are knock-down fittings?

- Knock-down fittings are a modern way of joining materials quickly and easily without the use of clamps and glue. They allow products to be dismantled and assembled whenever necessary.

Why are knock-down fittings used?

- Knock-down fittings provide simple constructions for difficult materials such as chipboard.
- Knock-down fittings allow for products such as wardrobes and kitchen units to be sold flat pack and assembled at home.

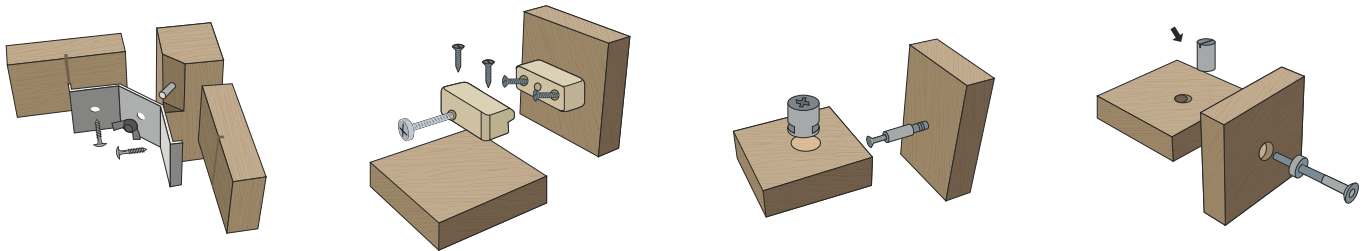

Advantages to manufacturers of using knock-down fittings:

(remember to use full sentences and justify your answers)

For consumers, what are the advantages of buying products with knock-down fittings:

(remember to use full sentences and justify your answers)

Knock-down Fittings

Type - Leg Plate

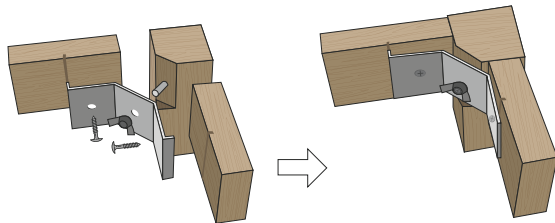

Description

Application

Type - Block connector or Corner block

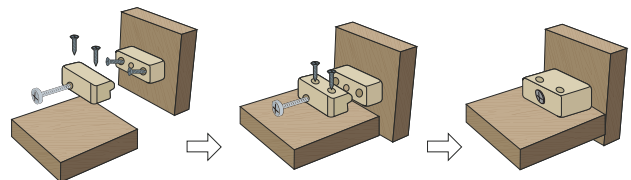

Description

Application

Type - Cam fittings

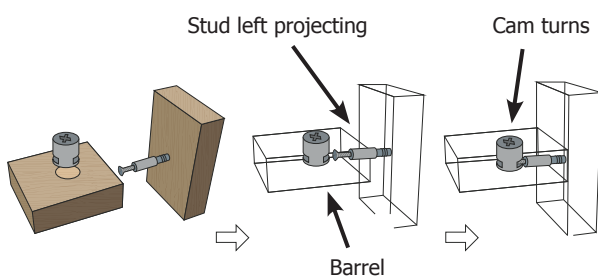

Description

- Consists of a stud screwed into one side and left projecting.
- The stud locates within a hole in the barrel.
- The barrel is turned with a cross-head screw driver which pulls the joint together.

Application

Type - Barrel nut and bolt

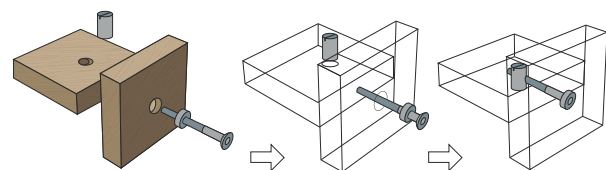

Description

- One of the strongest knock-down fittings.
- Consists of a threaded aluminium barrel which sits within a hole in the rail.
- A long machine screw locks into the barrel to create a strong joint.

Application